

# FAR NORTH DISTRICT COUNCIL



Our reference

All replies should be addressed to the District Secretary



TO:

Mr & Mrs Erwin

ADDRESS:

P.O. Box 5  
Omapere  
0451

RE: RESOURCE CONSENT NO. 1970574 - To construct a shop  
dwelling - State Highway 12 - Opononi/Omapere

Council staff will be monitoring compliance of the above mentioned resource consent week commencing 17th May 1999

This inspection is in pursuant to Section 35 of the Resource Management Act 1991.

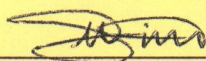
  
\_\_\_\_\_  
Carol Smith  
Monitoring Officer

11th May 1999  
Date

5/10/99



# FAR NORTH DISTRICT COUNCIL



Our reference RC 1970574

All replies should be addressed to the District Secretary

Brian & June Erwin  
P O Box 5  
OMAPERE 0451

25th November 1998

Dear Mr & Mrs Erwin

**RE. RESOURCE CONSENT 1970574 - TO CONSTRUCT A SHOP DWELLING  
EXCEEDING HEIGHT IN RELATION TO BOUNDARY - SH 12,  
OPONONI/OMAPERE**

Further to the above mentioned resource consent which was granted on the 12<sup>th</sup> February 1997 and the previous monitoring request letter dated 21<sup>st</sup> April 1997.

To enable this file to be closed would you please contact me as soon as possible to advise when an inspection can be undertaken.

I look forward to your early reply.

Yours faithfully

Carol Smith  
**MONITORING OFFICER**



# FAR NORTH DISTRICT COUNCIL



Our reference  
If calling, please ask for

RC 1970574 618-569  
Cathy Orevich

Kawakawa Service Centre  
Main North Rd, PO Box 11, Kawakawa  
Telephone: (09) 404-0371 Fax: (09) 404-1544

21 April, 1997

Brian & June Erwin  
P O Box 5  
OMAPERE 0451

23/4/97

4058817

Mrs Erwin will ring me in 2-3  
months for inspection.  
Cathy.

Dear Mr & Mrs Erwin,

**RE: RESOURCE CONSENT 1970574 - TO CONSTRUCT A SHOP  
DWELLING EXCEEDING HEIGHT IN RELATION TO BOUNDARY - SH 12,  
OPONONI/OMAPERE**

Further to the above-mentioned resource consent that was granted on the 12 February 1997.

There has been a condition applied which requires monitoring by Council staff, as follows:

- That parking be formed and provided on site in accordance with Council standards.

I would appreciate you contacting me at the Kawakawa Office to discuss an appropriate time for an inspection, if required, and to discuss the monitoring process.

I look forward to your co-operation in this regard.

Yours faithfully

Cathy Orevich  
**MONITORING OFFICER**



COVER SHEET.

RC No : 1970574

Document Type : Land use

Approved by MHS : P. J. Kallala

Date : 12/02/97



# FAR NORTH DISTRICT COUNCIL



Kawakawa Service Centre  
Main North Rd, PO Box 11, Kawakawa  
Telephone: (09) 404-0371 Fax: (09) 404-1544

Our reference RC 1970574

If calling, please ask for

Resource Planner

14 FEB 1997

B P & J A ERWIN  
BOX 5  
OMAPERE

Dear Sir/Madam,

RC 1970574 APPLICATION BY B P & J A ERWIN.

Council's decision is attached.

The application was considered and determined under authority delegated to the Manager, Environmental Services of the Far North District Council, pursuant to Section 34(4) of the Resource Management Act 1991. If you are dissatisfied with the decision of any part of it, you have the right (under Section 357 of the Act) to object to the decision. The objection must be in writing, stating reasons for the objection, and must be received by Council within 15 working days of your receipt of this decision.

Yours faithfully

W E SMITH  
RESOURCE PLANNER



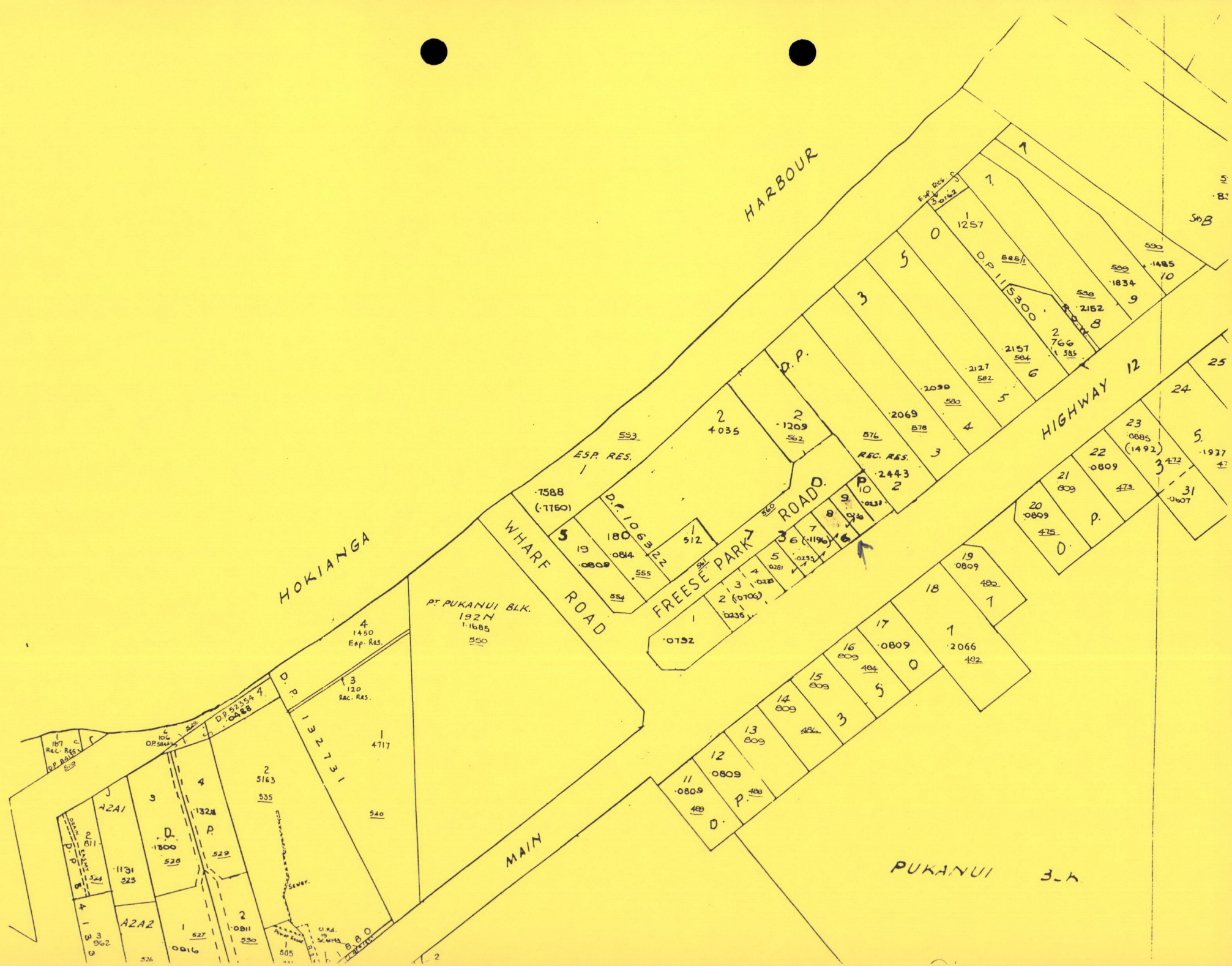



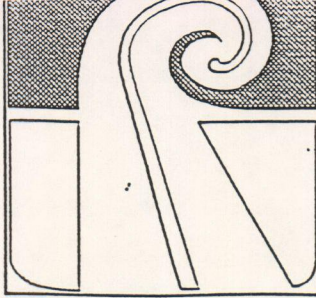

FAXED

# FAR NORTH DISTRICT COUNCIL

## KAWAKAWA SERVICE CENTRE

TELEPHONE: (09) 404-0371  
FAX: (09) 404-1544

STATE HIGHWAY ONE  
P O BOX 11  
KAWAKAWA 0292

### FAX TRANSMISSION SHEET

NUMBER OF PAGES (INCLUDING THIS SHEET):

5

TO:

ATTENTION:

FAX NUMBER:

DATE:

FROM:

MESSAGE:

Alistair

Wayne

Here is the Erwin Apple  
in short.

Cheers Wayne.

IF YOU HAVE NOT RECEIVED ALL THE PAGES OR FIND THAT ANY OF THEM  
ARE ILLEGIBLE, PLEASE CALL THE SENDER ON KAWAKAWA (09) 404-0371  
DURING BUSINESS HOURS. THANK YOU. D:\DATA\WP\GENERAL\MFAX.DOC : GME 15/2/94



Sit 12 Opononi / Ompere.

|                 |                |                  |
|-----------------|----------------|------------------|
| Commercial 1    | Hokuranga      | - permitted      |
| Settlement core | Proposed plan. | - Discretionary. |

NO SNA, OLV or SLV's

● Proposed building moved to ~~not~~ no become discretionary

Written approvals obtained

Assessment of effects. - provided but may be inadequate.

Permitted under old plan.

Site visit required

●



3 February 1997

Ms Adele Woodman  
Far North District Council  
Kawakawa Service Centre  
P O Box 11  
Kawakawa  
NORTHLAND



Our ref: 8/1/4/4  
Your ref: AFW:RC-1970574  
Code: mh1619.let

Dear Madam

**PROPOSED RESIDENTIAL BUILDING:  
LOTS 8 & 9, DP50736, SH12, OMAPERE,  
BRIAN & JUNE ERWIN**

I refer to the above resource consent application for our comments.

We have assessed the proposal in so far as its effects on the State Highway is concerned and are satisfied that it will not have any adverse effects on the operation of the road.

Transit New Zealand therefore approves the plan as submitted to the Council.

Yours faithfully

M S Hannif  
Resource Management Planner  
for Regional State Highway Manager

**Auckland Office**

9th Floor 48 Quay Street CPO Box 1459 Central Auckland  
Phone: (09) 377-7092 Fax: (09) 307-6843



# OMAPERE GLASS & PICTURE FRAMING

Glass supplies & re-glazing - Picture Framing - Security & Fly screen doors & windows - Ven-lu-ree Blinds  
Cat & Dog doors - Deadlocks for all doors

**BRIAN & JUNE ERWIN**

Postal: Box 5, Omapere  
Hokianga

Phone/Fax (09)4058817  
GST No 47-247-365

**DATE.** 21 November 1996

F.N.D.C.  
Rawene

## BUILDING CONSENT APPLICATION INFORMATION REQUIRED.

- 1:- COPY OF TITLE.
- 2 NO EXCAVATION FOR BUILDING. (REMOVAL OF TOPSOIL ONLY).
- 3 BUILDING TO OPERATE AS GLASS & PICTURE FRAMING. & FUTURE HARDWARE SUPPLIES.
- 4 NEW SITE PLAN TO BE SUPPLIED.



Transfer No.

N/C. Order No. 874917.1



## CERTIFICATE OF TITLE UNDER LAND TRANSFER ACT

This Certificate dated the 5th day of March one thousand nine hundred and Eighty-one under the seal of the District Land Registrar of the Land Registration District of North Auckland

WITNESSETH that KARL NORMAN FREESE of Whirinaki farmer, RUTH MARIE SPRINGETT of Whirinaki married woman and FLORENCE WINIFRED FREESE of Whangarei married woman as executors are

seised of an estate in fee-simple (subject to such reservations, restrictions, encumbrances, liens, and interests as are notified by memorial underwritten or endorsed hereon) in the land hereinafter described, delineated with bold black lines on the plan hereon be the several admeasurements a little more or less, that is to say: All that parcel of land containing 235 square metres more or less being Lot 8 Deposited Plan 50736 and being part Pukanui Block

Assistant Land Registrar

983811.1 Transfer to Malcolm Robert Pinkney of Kohukohu fisherman and Betty Pinkney his wife - 11.9.1981 at 9.01 o'clock

A.L.R.

C.416681.1 Mortgage to Westpac Banking Corporation - 24.9.1992 at 2.37 o'clock

A.L.R.

C.471320.2 Transfer to Brian Patrick Erwin of Hokiangia builder and June Ann Erwin his wife - 16.4.1993 at 1.45 o'clock

A.L.R.

C.825490.2 Mortgage to Countrywide Banking Corporation Limited - 23.3.1995 at 2.88 o'clock

A.L.R.

9C/234





## CERTIFICATE OF TITLE UNDER LAND TRANSFER ACT

This Certificate dated the 5th day of March one thousand nine hundred and Eighty-one under the seal of the District Land Registrar of the Land Registration District of North Auckland

WITNESSETH that KARL NORMAN FREESE of Whirinaki farmer, RUTH MARIE SPRINGETT of Whirinaki married woman and FLORENCE WINIFRED FREESE of Whangarei married woman as Executors are

is seized of an estate in fee-simple (subject to such reservations, restrictions, encumbrances, liens, and interests as are notified in the memorial underwritten or endorsed hereon) in the land hereinafter described, delineated with bold black lines on the plan hereon to be the several admeasurements a little more or less, that is to say: All that parcel of land containing 235 square metres more or less being Lot 9 Deposited Plan 50736 and being part Pukanui Block

*M. S. Crawford*  
Assistant Land Registrar

987811.1 Transfer to Malcolm Robert Pinkney of Kohukohu fisherman and Betty Pinkney his wife - 11.9.1981 at 9.01 o/c

*[Signature]*  
A.L.R.

C.416681.1 Mortgage to Westpac Banking Corporation - 24.9.1992 at 2.57 o/c

C706723

*[Signature]*  
A.L.R.

C.825490.1 Transfer to Brian Patrick Erwin of Hokianga builder and June Ann Erwin his wife - 23.3.1995 at 2.58 o/c

*[Signature]*  
A.L.R.

C.825490.2 Mortgage to Countrywide Banking Corporation Limited - 23.3.1995 at 2.58 o/c

*[Signature]*  
A.L.R.

49 C / 235



BC 970172.



**FAR NORTH  
DISTRICT COUNCIL**

MEMORIAL AVENUE, KAIKOHE  
TELEPHONE 0-9-401 2101

**OFFICIAL RECEIPT**

G.S.T. REG. No. 52-004-926

**SERVICE CENTRES:-**

KAIKOHE Ph 0-9-401 2101  
KAITAIA Ph 0-9-408 1400  
KERIKERI Ph 0-9-407 7033

RAWENE Ph 0-9-405 7829  
KAEO Ph 0-9-405 0297  
KAWAKAWA Ph 0-9-404 0371

| NAME AND ADDRESS DETAILS       | ASSESSMENT No.<br>ACCOUNT No. | AMOUNT<br>RECEIVED |
|--------------------------------|-------------------------------|--------------------|
| BP & JA ERWIN<br>OMAPERE GLASS | 011101512520040004            | 400.00             |
| Chq BP & JA ERWIN              |                               |                    |

RECEIPT No.

DATE

BLDG ACT - BLDG CONSENTS

002091

11-Dec-96 AMOUNT  
TENDERED

CASH

\$0.00 CHANGE  
\$400.00

\$0.00

DP:53/TT:075

MOORE SPEEDICARRIER



APPROVAL BY A PERSON AFFECTED  
BY AN  
APPLICATION FOR A RESOURCE CONSENT

To be completed by the person requesting approval :

APPLICANT : BRIAN & JUNE ERWIN.

PROPOSED ACTIVITY : GLASS & PICTURE FRAMING SUPPLIES.  
FUTURE HARDWARE.

LOCATION : LOTS 8 & 9 S.H. 12. OMAPERE

.....  
To be completed by person giving their approval :

I have/~~have not~~ inspected the plans and information for the above activity.

I hereby give/~~do not~~ give my approval for it to proceed as presented.

I understand that, if I give my approval, the District Council shall take no account of the effect of the activity on me, when it is considering the application.

We are occupiers

~~I am an owner/shareholder/occupier~~ of the following property (street number or legal description) SH 12, Omapere NEXT DOOR - EAST SIDE.

J. A. Callagher.  
J. A. Callagher  
{Signature}

J. A. Callagher.  
A. P. CALLAGHER.  
{Print Name}

Any additional comments you may wish to make :

\_\_\_\_\_  
\_\_\_\_\_  
\_\_\_\_\_

Date : 4-12-96

Phone No. : 4058 889.

This form has been prepared by the Far North District Council.

If you have any queries about this form or the reasons it is required please contact the nearest Service Centre or District Planning Office.

NOTE:

If you do not understand what this form is for do not sign it. However should you sign the form and change your mind you may still withdraw your approval prior to a decision. Please notify Council immediately otherwise a decision will be made on the application, presuming your approval.



APPROVAL BY A PERSON AFFECTED  
BY AN  
APPLICATION FOR A RESOURCE CONSENT

To be completed by the person requesting approval :

APPLICANT : BRIAN & JUNE ERWIN.

PROPOSED ACTIVITY : GLASS & PICTURE FRAMING SUPPLIES.  
FUTURE HARDWARE.

LOCATION : LOTS 8 & 9 S.H. 12. OMAPERE

.....  
To be completed by person giving their approval :

I have/~~have not~~ inspected the plans and information for the above activity.

I hereby give/~~do not~~ give my approval for it to proceed as presented.

I understand that, if I give my approval, the District Council shall take no account of the effect of the activity on me, when it is considering the application.

I am an owner/~~shareholder/occupier~~ of the following property (street number or legal description) Lot 7 SH 12 OMAPERE

G. Murtagh.

{Signature}

GRAEME MURTAGH.

{Print Name}

Any additional comments you may wish to make :

\_\_\_\_\_  
\_\_\_\_\_

Date : 30/11/96

Phone No. : 4058777

This form has been prepared by the Far North District Council.

If you have any queries about this form or the reasons it is required please contact the nearest Service Centre or District Planning Office.

NOTE:

If you do not understand what this form is for do not sign it. However should you sign the form and change your mind you may still withdraw your approval prior to a decision. Please notify Council immediately otherwise a decision will be made on the application, presuming your approval.



APPROVAL BY A PERSON AFFECTED  
BY AN  
APPLICATION FOR A RESOURCE CONSENT

To be completed by the person requesting approval :

APPLICANT : BRIAN & JUNE ERWIN.

PROPOSED ACTIVITY : GLASS & PICTURE FRAMING SUPPLIES.

FUTURE HARDWARE.

LOCATION : LOTS 8 & 9 S.H.12. OMAPERE

.....  
To be completed by person giving their approval :

I have/~~have not~~ inspected the plans and information for the above activity.

I hereby give/~~do not~~ give my approval for it to proceed as presented.

I understand that, if I give my approval, the District Council shall take no account of the effect of the activity on me, when it is considering the application.

I am an owner/~~shareholder~~/occupier of the following property (street number or legal description) S.H.12 Omapere.

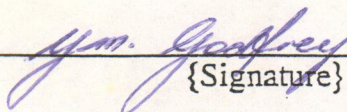
  
{Signature}

Yvonne Marie Godfrey  
{Print Name}

Any additional comments you may wish to make :

\_\_\_\_\_  
\_\_\_\_\_  
\_\_\_\_\_

Date : 1- 12- 96

Phone No. : 4075578

This form has been prepared by the Far North District Council.

If you have any queries about this form or the reasons it is required please contact the nearest Service Centre or District Planning Office.

NOTE:

If you do not understand what this form is for do not sign it. However should you sign the form and change your mind you may still withdraw your approval prior to a decision. Please notify Council immediately otherwise a decision will be made on the application, presuming your approval.



APPROVAL BY A PERSON AFFECTED  
BY AN  
APPLICATION FOR A RESOURCE CONSENT

To be completed by the person requesting approval :

APPLICANT : BRIAN & JUNE ERWIN.

PROPOSED ACTIVITY : GLASS & PICTURE FRAMING SUPPLIES.  
FUTURE HARDWARE.

LOCATION : LOTS 8 & 9 S.H.12. OMAPERE

.....  
To be completed by person giving their approval :

I have/~~have not~~ inspected the plans and information for the above activity.

I hereby give/~~do not give my~~ approval for it to proceed as presented.

I understand that, if I give my approval, the District Council shall take no account of the effect of the activity on me, when it is considering the application.

I am an owner/shareholder/occupier of the following property (street number or legal description) Neighbour directly East of proposed dwelling

Cynthia Hedger  
B. A. De

{Signature}

Cynthia Hedger  
Melwyn Hedger

{Print Name}

Any additional comments you may wish to make :

Date : 25th November 1996

Phone No. : 09-4258-881

This form has been prepared by the Far North District Council.

If you have any queries about this form or the reasons it is required please contact the nearest Service Centre or District Planning Office.

NOTE:

If you do not understand what this form is for do not sign it. However should you sign the form and change your mind you may still withdraw your approval prior to a decision. Please notify Council immediately otherwise a decision will be made on the application, presuming your approval.



APPROVAL BY A PERSON AFFECTED  
BY AN  
APPLICATION FOR A RESOURCE CONSENT

To be completed by the person requesting approval :

APPLICANT : BRIAN & JUNE ERWIN.

PROPOSED ACTIVITY : GLASS & PICTURE FRAMING SUPPLIES.

FUTURE HARDWARE.

LOCATION : LOTS 8 & 9 S.H.12. OMAPERE

.....  
To be completed by person giving their approval :

I have/~~have not~~ inspected the plans and information for the above activity.

I hereby give/~~do not give~~ my approval for it to proceed as presented.

I understand that, if I give my approval, the District Council shall take no account of the effect of the activity on me, when it is considering the application.

I am an owner/~~shareholder~~/occupier of the following property (street number or legal description) Lot 19 DP 35077 Bk VII Hokiang

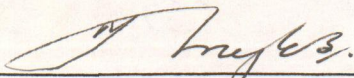
  
{Signature}

TCG MYLES  
{Print Name}

Any additional comments you may wish to make :

\_\_\_\_\_  
\_\_\_\_\_

Date : 27<sup>th</sup> November 1996

Phone No. 03-57-88656

This form has been prepared by the Far North District Council.

If you have any queries about this form or the reasons it is required please contact the nearest Service Centre or District Planning Office.

NOTE:

If you do not understand what this form is for do not sign it. However should you sign the form and change your mind you may still withdraw your approval prior to a decision. Please notify Council immediately otherwise a decision will be made on the application, presuming your approval.



# FAR NORTH DISTRICT COUNCIL



Our reference

AFW: RC 1970574

Kawakawa Service Centre  
Main North Rd, PO Box 11, Kawakawa  
Telephone: (09) 404-0371 Fax: (09) 404-1544

If calling, please ask for

Adele Woodman

20 December 1996

B P & J A Erwin  
Box 5  
OMAPERE  
Hokianga

Dear Sir/Madam,

**RESOURCE CONSENT - RC NO. 1970574**  
**YOUR REF: CONSTRUCT NEW DWELLING - SH12 OMAPERE**

Receipt is acknowledged of the above mentioned Resource Consent. Please refer to RC 1970574 in all future correspondence relating to this Resource Consent.

It is a requirement that Council Officers and anyone specifically authorised by Council are able to have access to the property during working hours for the purpose of inspection and appraisal of the site. If this requirement is not to your satisfaction please advise in writing within five days of the date of this letter.

As required under the Resource Management Act 1991, Council will endeavour to issue a decision on the application within twenty (20) working days,<sup>a</sup> providing that all necessary information is submitted with the application and does not need to be publicly notified, pursuant to Section 93 of the Resource Management Act 1991.

<sup>a</sup> In terms of Section 2 of the Resource Management Act 1991, working days exclude those days from 20 December 1996 to 15 January 1997. However, we will continue to process.

Yours faithfully

**Adele Woodman**  
ENVIRONMENTAL SERVICES ADMINISTRATOR



# FAR NORTH DISTRICT COUNCIL



Kawakawa Service Centre  
Main North Rd, PO Box 11, Kawakawa  
Telephone: (09) 404-0371 Fax: (09) 404-1544

Our reference AFW:RC 1970574

If calling, please ask for  
Adele Woodman

20 December 1996

N Z Historic Places Trust  
P O Box 105-291  
C M Centre  
**AUCKLAND 1**

Dear Sir/Madam,

**RE: RC 1970574 - LAND USE APPLICATION BY B P & J A ERWIN**

Your agency may have an interest in the attached application.

Could you please advise us of any requirements or comments you may have within 10 working days. If no reply is received within this period it will be assumed that the Historic Places Trust has no interest in this application.

Thank you for your assistance.

Yours faithfully,

**Adele Woodman**  
ENVIRONMENTAL SERVICES ADMINISTRATOR



new dwelling.



# FAR NORTH DISTRICT COUNCIL



Kawakawa Service Centre  
Main North Rd, PO Box 11, Kawakawa  
Telephone: (09) 404-0371 Fax: (09) 404-1544

Our reference AFW: RC 1970574

If calling, please ask for  
Adele Woodman

20 December 1996

Works Consultancy Services  
Private Bag 9017  
WHANGAREI

Dear Sir,

RE: RESOURCE CONSENT - 1970574

Attached please find a letter and plan in respect of the above for your comments.

Your comments would be appreciated **within 10 days**.

Yours faithfully,

**Adele Woodman**  
**ENVIRONMENTAL SERVICES ADMINISTRATOR**

**COPY TO:**  
**TRANSIT NEW ZEALAND**  
**P O BOX 1459**  
**CENTRAL AUCKLAND**



# Fax

Pages: 4

Date: 13/12/96

Attention Julie

F.N.D.C. Kawakawa.

Thanks!

June Ewing

From the desk of...

OMAPERE GLASS & PICTURE FRAMING  
BOX 5,  
OMAPERE, N.Z.  
S.H. 12 OMAPERE, NORTHLAND.  
(09) 4058817  
Facsimile: (09) 4058817



TO : Far North District Council

I. BRIAN PATRICK & JUNE ANN ERWIN {Full Name}  
 of SH 12, OMAPERE {Address}

apply for a Resource Consent for the Land Use activity described below :

1. The names and addresses of the owner and occupier (other than the applicant) of any land to which the application relates are as follows :  
 .....
2. The location to which this application relates is :  
 {Street/Road Address} SH 12, OMAPERE  
 {Legal Description} Lots 8 & 9 DP 50736 Pukanui Block  
 {Valuation Roll Number} 00618-569-00
3. A description of the activity to which the application relates is : {Please attach plans}  
 .....  
 .....
4. The following additional resource consents are required in relation to this proposal and have/have not been applied for :  
 .....  
 .....
5. Yes/No I attach an assessment of any effects that the proposed activity may have on the environment in accordance with the Fourth Schedule to the Act. {If required}
6. Yes/No I attach other information (if any), required to be included in the application by the District Plan or regulations.
7. ☒ Yes/No Letters of consent from affected persons. {Optional}
8. Yes/No Any other information. {Please specify}

The above information is true and complete to the best of my knowledge. I understand that Council is relying on this information in making its decision on the Resource Consent.

Dated : 13/12/96

Signature of Applicant : B. Patrick & J.A. Erwin  
 or person authorised to :  
 to sign on behalf :

Please print name : BRIAN PATRICK & JUNE ANN ERWIN

Address for Service : Box 5, OMAPERE, HOKIANGA

Telephone Numbers : {Business} 4058817 {Fax} SAME {Home} SAME

This application will not be received in accordance with the Resource Management Act unless accompanied by the minimum estimated charge. The minimum estimated charge is an assessment of the cost to process the application. Should the processing exceed that amount then Council will require an additional amount to be paid, based on actual and reasonable costs.

To assess this charge please indicate whether the above activity was a \*Predominant Use, Controlled Use, Conditional Use or a Specified Departure under the former District Scheme. { \* Delete that which does not apply }



## ASSESSMENT OF EFFECTS ON THE ENVIRONMENT

This form is a simplified version of the Fourth Schedule of the Resource Management Act, for use with applications of a minor scale or significance. It is to assist you in assessing the effects of your proposal on the environment. The meaning of the word "environment" includes ecosystems; people and communities; natural and physical resources; amenity values; and social, economic, aesthetic and cultural conditions affecting or affected by these.

As well, the Act requires you to identify the persons interested in or affected by your proposal; the consultation undertaken, and any response to the views of those consulted. Please attach a report on this consultation, including who was consulted, the date, the outcomes of the discussion, and any agreements, concerns, or amendments requested to the proposal.

| Effects on the Environment                                 | Please explain any effects.<br>Continue on a separate sheet if necessary. | How will you remedy or mitigate these effects?<br>Continue on a separate sheet if necessary. |
|--|---|--|
| Will the proposal have physical effects on:                |   |  |
| Terrain (eg earthworks, roading)                           | /   |  |
| Vegetation (esp. indigenous plants)                        | /   |  |
| Existing uses or structures                                | /   |  |
| Animals or their habitats                                  | /   |  |
| Will it have visual effects on:                            |   |  |
| Landscape  | /   |  |
| Coastal character  | /   |  |
| Community character  | /   |  |
| Natural character  | /   |  |
| Will it be located on or near a place or structure having: |   |  |
| Aesthetic value  | /   |  |
| Spiritual value  | /   |  |
| Scientific value   | /   |  |
| Historic value   | /   |  |

13-12-1996 15:12

FROM 2209 4058158  
4058158

TO 050094041544  
1996, 12-13

13:27

P.01  
#415 P.04/04



| Effects on the Environment                                    | Please explain any effects.<br>Continue on a separate sheet if necessary. | How will you remedy or mitigate these effects?<br>Continue on a separate sheet if necessary. |
|---|---|--|
| Recreational value  | /   |  |
| Cultural value  | /   |  |
| Other special value   | /   |  |
| Will it discharge contaminants to:                            |   |  |
| Air   | /   |  |
| Land  | /   |  |
| Water (ground, surface; marine, fresh)                        | /   |  |
| Will it emit noise?   | /   |  |
| Will it create or increase risks through:                     |   |  |
| Natural hazards (eg: flood, instability)                      | /   |  |
| Hazardous substances  | /   |  |
| Hazardous installations                                       | /   |  |
| Will the proposal directly, or as a result of the above have: |   |  |
| Social effects  | /   |  |
| Economic effects  | /   |  |
| Health effects  | /   |  |
| Cultural effects  | /   |  |
| Any other effects   | /   |  |

- Structures include buildings, roads, walkways, water, sewage or stormwater treatment or reticulation systems, or anything else built on land or attached to the bottom of a water body.



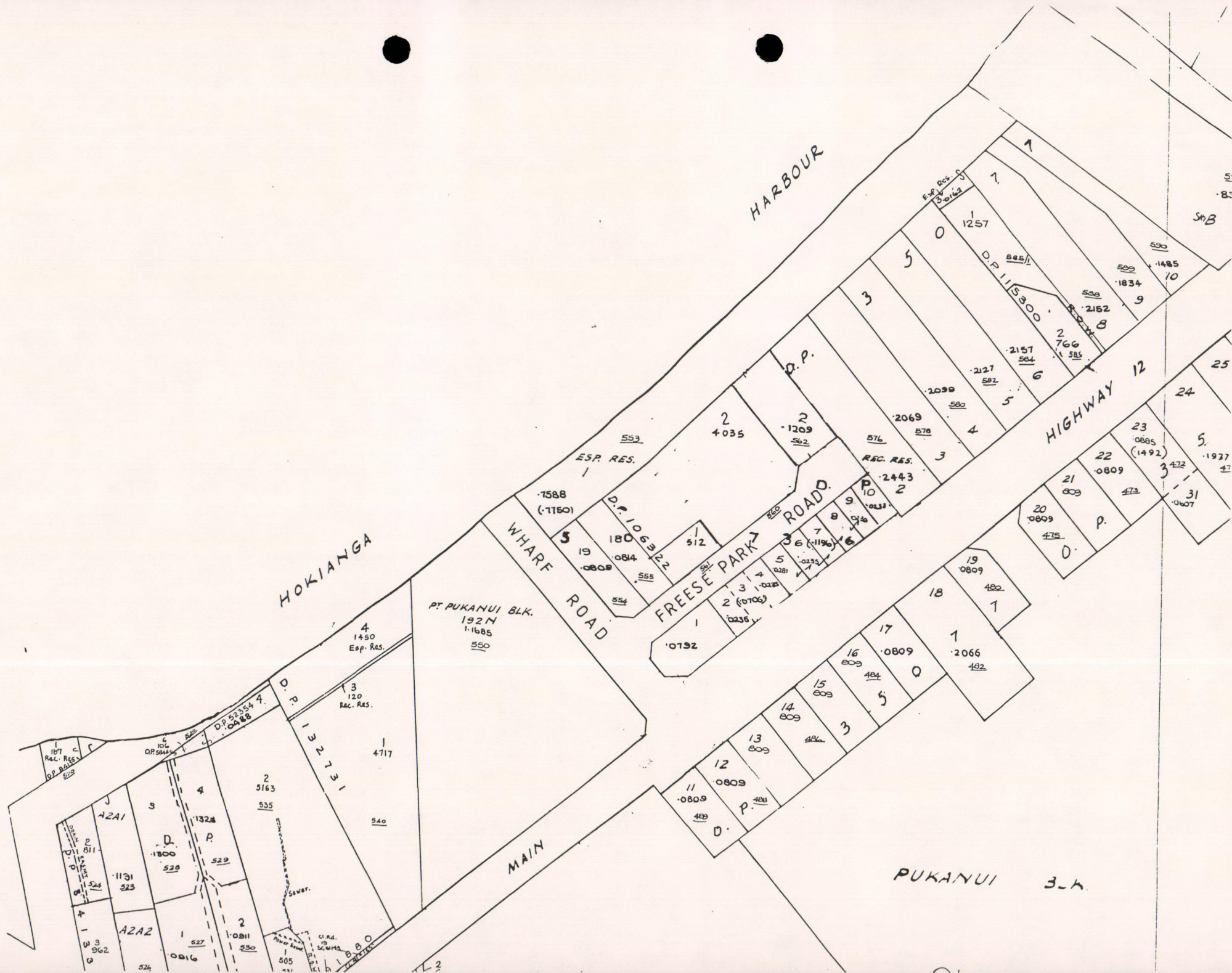

HARBOR

HOKIANGA

WHARF ROAD

FREESE PARK ROAD

HIGHWAY 12

MAIN

PUKANUI BLK.

PT. PUKANUI BLK.  
192 N  
1-1685  
550

ESP. RES.

REC. RES.

4  
1450  
Esp. Res.

3  
120  
Rec. Res.

2  
5163  
535

1  
1800  
529

1  
962  
524

1  
107  
R.C. Res.  
523

6  
106  
OP. Res.  
523

4  
57354  
D.P. 0688

1  
4717  
540

1  
1324  
529

2  
5163  
535

3  
120  
Rec. Res.

4  
1450  
Esp. Res.

5  
1800  
529

6  
106  
OP. Res.

7  
107  
R.C. Res.

8  
57354  
D.P. 0688

9  
1324  
529

10  
4717  
540

11  
5163  
535

12  
1800  
529

13  
106  
OP. Res.

14  
107  
R.C. Res.

15  
57354  
D.P. 0688

16  
1324  
529

17  
4717  
540

18  
5163  
535

19  
1800  
529

20  
106  
OP. Res.

21  
107  
R.C. Res.

22  
57354  
D.P. 0688

23  
1324  
529

24  
4717  
540

25  
5163  
535

26  
1800  
529

27  
106  
OP. Res.

28  
107  
R.C. Res.

29  
57354  
D.P. 0688

30  
1324  
529

31  
4717  
540

32  
5163  
535

33  
1800  
529

34  
106  
OP. Res.

35  
107  
R.C. Res.

36  
57354  
D.P. 0688

37  
1324  
529

38  
4717  
540

39  
5163  
535

40  
1800  
529

41  
106  
OP. Res.

42  
107  
R.C. Res.

43  
57354  
D.P. 0688

44  
1324  
529

45  
4717  
540

46  
5163  
535

47  
1800  
529

48  
106  
OP. Res.

49  
107  
R.C. Res.

50  
57354  
D.P. 0688

51  
1324  
529

52  
4717  
540

53  
5163  
535

54  
1800  
529

55  
106  
OP. Res.

56  
107  
R.C. Res.

57  
57354  
D.P. 0688

58  
1324  
529

59  
4717  
540

60  
5163  
535

61  
1800  
529

62  
106  
OP. Res.

63  
107  
R.C. Res.

64  
57354  
D.P. 0688

65  
1324  
529

66  
4717  
540

67  
5163  
535

68  
1800  
529

69  
106  
OP. Res.

70  
107  
R.C. Res.

71  
57354  
D.P. 0688

72  
1324  
529

73  
4717  
540

74  
5163  
535

75  
1800  
529

76  
106  
OP. Res.

77  
107  
R.C. Res.

78  
57354  
D.P. 0688

79  
1324  
529

80  
4717  
540

81  
5163  
535

82  
1800  
529

83  
106  
OP. Res.

84  
107  
R.C. Res.

85  
57354  
D.P. 0688

86  
1324  
529

87  
4717  
540

88  
5163  
535

89  
1800  
529

90  
106  
OP. Res.

91  
107  
R.C. Res.

92  
57354  
D.P. 0688

93  
1324  
529

94  
4717  
540

95  
5163  
535

96  
1800  
529

97  
106  
OP. Res.

98  
107  
R.C. Res.

99  
57354  
D.P. 0688

100  
1324  
529

101  
4717  
540

102  
5163  
535

103  
1800  
529

104  
106  
OP. Res.

105  
107  
R.C. Res.

106  
57354  
D.P. 0688

107  
1324  
529

108  
4717  
540

109  
5163  
535

110  
1800  
529

111  
106  
OP. Res.

112  
107  
R.C. Res.

113  
57354  
D.P. 0688

114  
1324  
529

115  
4717  
540

116  
5163  
535

117  
1800  
529

118  
106  
OP. Res.

119  
107  
R.C. Res.

120  
57354  
D.P. 0688

121  
1324  
529

122  
4717  
540

123  
5163  
535

124  
1800  
529

125  
106  
OP. Res.

126  
107  
R.C. Res.

127  
57354  
D.P. 0688

128  
1324  
529

129  
4717  
540

130  
5163  
535

131  
1800  
529

132  
106  
OP. Res.

133  
107  
R.C. Res.

134  
57354  
D.P. 0688

135  
1324  
529

136  
4717  
540

137  
5163  
535

138  
1800  
529

139  
106  
OP. Res.

140  
107  
R.C. Res.

141  
57354  
D.P. 0688

142  
1324  
529

143  
4717  
540

144  
5163  
535

145  
1800  
529

146  
106  
OP. Res.

147  
107  
R.C. Res.

148  
57354  
D.P. 0688

149  
1324  
529

150  
4717  
540

151  
5163  
535

152  
1800  
529

153  
106  
OP. Res.

154  
107  
R.C. Res.

155  
57354  
D.P. 0688

156  
1324  
529

157  
4717  
540

158  
5163  
535

159  
1800  
529

160  
106  
OP. Res.

161  
107  
R.C. Res.

162  
57354  
D.P. 0688

163  
1324  
529

164  
4717  
540

165  
5163  
535

166  
1800  
529

167  
106  
OP. Res.

168  
107  
R.C. Res.

169  
57354  
D.P. 0688

170  
1324  
529

171  
4717  
540

172  
5163  
535

173  
1800  
529

174  
106  
OP. Res.

175  
107  
R.C. Res.

176  
57354  
D.P. 0688

177  
1324  
529

178  
4717  
540

179  
5163  
535

180  
1800  
529

181  
106  
OP. Res.

182  
107  
R.C. Res.

183  
57354  
D.P. 0688

184  
1324  
529

185  
4717  
540

186  
5163  
535

187  
1800  
529

188  
106  
OP. Res.

189  
107  
R.C. Res.

190  
57354  
D.P. 0688

191  
1324  
529

192  
4717  
540

193  
5163  
535

194  
1800  
529

195  
106  
OP. Res.

196  
107  
R.C. Res.

197  
57354  
D.P. 0688

198  
1324  
529

199  
4717  
540

200  
5163  
535

201  
1800  
529

202  
106  
OP. Res.

203  
107  
R.C. Res.

204  
57354  
D.P. 0688

205  
1324  
529

206  
4717  
540

207  
5163  
535

208  
1800  
529

209  
106  
OP. Res.

210  
107  
R.C. Res.

211  
57354  
D.P. 0688

212  
1324  
529

213  
4717  
540

214  
5163  
535

215  
1800  
529

216  
106  
OP. Res.

217  
107  
R.C. Res.

218  
57354  
D.P. 0688

219  
1324  
529

220  
4717  
540

221  
5163  
535

222  
1800  
529

223  
106  
OP. Res.

224  
107  
R.C. Res.

225  
57354  
D.P. 0688

226  
1324  
529

227  
4717  
540

228  
5163  
535

229  
1800  
529

230  
106  
OP. Res.

231  
107  
R.C. Res.

232  
57354  
D.P. 0688

233  
1324  
529

234  
4717  
540

235  
5163  
535

236  
1800  
529

237  
106  
OP. Res.

238  
107  
R.C. Res.

239  
57354  
D.P. 0688

240  
1324  
529